

United States Department of the Interior
National Park Service

National Register of Historic Places
Inventory—Nomination Form

For NPS use only
received AUG 26 1983
date entered

See instructions in *How to Complete National Register Forms*
Type all entries—complete applicable sections

1. Name

historic ^{TR} Banking Facilities in Ellis Co., Oklahoma

and/or common N/A

2. Location

street & number Multiple Locations N/A not for publication

city, town NA vicinity of

state OK code county Ellis code

3. Classification

Category	Ownership	Status	Present Use	
<input type="checkbox"/> district	<input type="checkbox"/> public	<input type="checkbox"/> occupied	<input type="checkbox"/> agriculture	<input type="checkbox"/> museum
<input type="checkbox"/> building(s)	<input type="checkbox"/> private	<input type="checkbox"/> unoccupied	<input type="checkbox"/> commercial	<input type="checkbox"/> park
<input type="checkbox"/> structure	<input type="checkbox"/> both	<input type="checkbox"/> work in progress	<input type="checkbox"/> educational	<input type="checkbox"/> private residence
<input type="checkbox"/> site	Public Acquisition	Accessible	<input type="checkbox"/> entertainment	<input type="checkbox"/> religious
<input type="checkbox"/> object	<input type="checkbox"/> N/A in process	<input type="checkbox"/> yes: restricted	<input type="checkbox"/> government	<input type="checkbox"/> scientific
<input checked="" type="checkbox"/> Thematic	<input type="checkbox"/> N/A being considered	<input type="checkbox"/> yes: unrestricted	<input type="checkbox"/> industrial	<input type="checkbox"/> transportation
		<input type="checkbox"/> no	<input type="checkbox"/> military	<input type="checkbox"/> other:

4. Owner of Property

name Multiple Ownership

street & number

city, town NA vicinity of state

5. Location of Legal Description

courthouse, registry of deeds, etc. Town Hall, Shattuck, Ok; Stock Exchange Bank, Woodward, Independence Owners.

street & number

city, town state

6. Representation in Existing Surveys

title Oklahoma Historical Preservation Survey has this property been determined eligible? yes no

date 1982 federal state county local

depository for survey records Preservation Office, Oklahoma Historical Society

city, town Oklahoma City state Oklahoma

7. Description

Condition		Check one	Check one
<input type="checkbox"/> excellent	<input type="checkbox"/> deteriorated	<input type="checkbox"/> unaltered	<input type="checkbox"/> original site
<input checked="" type="checkbox"/> good	<input type="checkbox"/> ruins	<input type="checkbox"/> altered	<input type="checkbox"/> moved date <u> N/A </u>
<input type="checkbox"/> fair	<input type="checkbox"/> unexposed		

See individual nominations

Describe the present and original (if known) physical appearance

All the buildings in this nomination are related to the first banking efforts in Ellis County and as such were instrumental in the development of the area both commercially and agriculturally. Ellis county is predominantly arid, flat and dry. The most readily grown crop is wheat and most of the commercial and agricultural structures in the county are oriented toward this crop. Other cash returns for the residents lie mainly in cattle raising and oil production.

There are four towns in the county with 500 or more population; Shattuck, Gage, Fargo, and Arnett, the county seat. The population of the county as of the latest census is 5596, with most of that population dispersed into the outlying farmlands. Only Shattuck has a population that exceeds one thousand. Most of the county was settled between 1901 and 1906, with a large influx of immigrants of Russian-German ancestry.

The dominant architectural characteristic of the towns is simple, functional, one or two story buildings laid out in linear main-street configuration. The prairie environment generally dictates the necessity for keeping structures low and small, particularly before the advent of interior climate control. Most structures are built of stone or brick. The county has few recreational facilities as the dry flatlands do not promote much recreation. Hunting and fishing are popular and these sports also have contributed to cultural developments of the residents of the county.

Many of the bank buildings are similar in construction techniques and materials. They are mostly rectangular structures with entranceways on a cutaway corner. The buildings give the general architectural impression of either the Romanesque or Greek Revival style. Most of the buildings are constructed of brick and all are flat-roofed, one or two story structures. The buildings are generally the same size and the interiors had the same type fixtures, generally oak and marble. All the structures have pressed tin ceilings still in place and the original bank vaults are also in the buildings. Overall, the buildings maintain a similarity that express harshness and isolation resulting in basic, functional structures.

The survey was conducted by John Wensorski, a graduate masters student at Oklahoma State University concentrating on Historical Preservation. All of the county was surveyed and no subsurface archeological testing was conducted as the nomination is considered complete without such tests. Information from the Oklahoma State Banking Commission and the Woodward County Historical Museum was used to identify and assess properties. Numerous individual interviews and newspaper searches also provided informational data and materials for this nomination.

8. Significance

Period	Areas of Significance—Check and justify below			
<input type="checkbox"/> prehistoric	<input type="checkbox"/> archeology-prehistoric	<input type="checkbox"/> community planning	<input type="checkbox"/> landscape architecture	<input type="checkbox"/> religion
<input type="checkbox"/> 1400-1499	<input type="checkbox"/> archeology-historic	<input type="checkbox"/> conservation	<input type="checkbox"/> law	<input type="checkbox"/> science
<input type="checkbox"/> 1500-1599	<input type="checkbox"/> agriculture	<input checked="" type="checkbox"/> economics	<input type="checkbox"/> literature	<input type="checkbox"/> sculpture
<input type="checkbox"/> 1600-1699	<input type="checkbox"/> architecture	<input type="checkbox"/> education	<input type="checkbox"/> military	<input type="checkbox"/> social/
<input type="checkbox"/> 1700-1799	<input type="checkbox"/> art	<input type="checkbox"/> engineering	<input type="checkbox"/> music	<input type="checkbox"/> humanitarian
<input type="checkbox"/> 1800-1899	<input checked="" type="checkbox"/> commerce	<input type="checkbox"/> exploration/settlement	<input type="checkbox"/> philosophy	<input type="checkbox"/> theater
<input checked="" type="checkbox"/> 1900-	<input type="checkbox"/> communications	<input type="checkbox"/> industry	<input type="checkbox"/> politics/government	<input type="checkbox"/> transportation
		<input type="checkbox"/> invention		<input type="checkbox"/> other (specify)

Specific dates 1901-1924

Builder/Architect

Statement of Significance (in one paragraph)

These buildings are historically significant because they are the remaining buildings used to house the first banking facilities instituted in Ellis County. These facilities were instrumental in the development of this area not only commercially but agriculturally. Between the years 1901 and 1924, seventeen banks were chartered or converted as evidenced by the Oklahoma State Banking Commission. These institutions were distributed between the four towns of Shattuck, Gage, Fargo, and Arnett, with three banks in Gage, two in both Arnett and Fargo, and Shattuck garnering the remaining ten. These banks provided regular banking services to both the town and the surrounding community and contributed greatly to the development and growth of the area by making loans for farm purchases and improvements, business loans for purchase and/or expansion, and a ready cash flow to induce new settlers and immigrants to remain in the county. Although some of the institutions failed during the troubled times of the twenties and thirties, most would survive to provide continued services to the community, often depending on the personal assets and honest of the stockholders to stay in business. Many of the banks provided services to the community that would be considered unorthodox today, such as, remaining open as late as there were customers to be served. During the depression, and "dust bowl" years of the thirties, those banks that remained solvent helped to stabilize the community economically through continuity of banking services.

Organized by early pioneers to Ellis County such as, J.J. Hamre, A.M. Benbrook, J.H.C. Stuart, J.L. Pryor, John A. Holt, and C.Q. Chandler of Kansas, many of the banks were started with capital investments as low as \$10,000 that sum often being the entire assets of the founder. Far-sighted businessmen who saw the need for banking facilities within the community would respond to a bank's closing by quickly organizing another bank. This attitude has resulted in the prosperity of the county with the result that the towns of Arnett, Shattuck and Gage all have modern facilities that have flourished over the years and are stable foundations for continuous community development.

The institutions that came into being between 1910 and 1924 were distributed in the following manner and remained in existence during the periods indicated:

SHATTUCK

DATES

Commercial Bank	11 June 1903-5 August 1909
✓ First State Bank	7 July 1905-26 August 1910
Farmers and Merchants Bank	23 July 1908-?
Guarantee Bank	5 August 1909-4 September 1916
Shattuck State Bank	8 July 1910- 7 April 1911
First State Bank of Shattuck	26 August 1910- 4 October 1911
✓ Shattuck National Bank	7 April 1911- present
German-American State Bank	24 September 1911- 9 November 1912
✓ Bank of Shattuck	9 November 1912- 15 May 1924
Home State Bank of Shattuck	19 July 1919- 23 September 1922

ARNETT

Ellis County Bank

8 October 1907-6 December 1924

(See continuation Sheet)

UNITED STATES DEPARTMENT OF THE INTERIOR
NATIONAL PARK SERVICE

FOR NPS USE ONLY

RECEIVED

DATE ENTERED

**NATIONAL REGISTER OF HISTORIC PLACES
INVENTORY -- NOMINATION FORM**

CONTINUATION SHEET

ITEM NUMBER #8

PAGE 1

ARNETT

DATES

✓ Farmers and Merchants Bank

31 October 1908- Present

GAGE

✓ Bank of Gage

6 June 1910-22 October 1921

✓ Farmers State Bank

22 November 1905- 27 January 1923

22 March 1923- 22 May 1924

First State Bank of Gage

4 August 1924- Present

FARGO

✓ Stock Exchange Bank

1 May 1903- 19 June 1939

Farmers Exchange Bank

22 May 1908- 16 June 1910

Only one bank remains in its original building, all others still in operation having moved to newer, more modern facilities. All of the remaining bank buildings, save one, have continued to provide housing for various community businesses and social organizations and are all in use at this time. These buildings are being used commercially except for the Shattuck National building which is being used as the public library. The subdued Romanesque theme that is evident in most of these structures conveys the idea of solidity and stability desirable of new businesses looking for a place of residency and naturally attracted continuous use over the years.

All of the existing bank buildings in Ellis County have been included in this nomination with the exception of the facility that housed the Guarantee State Bank, which could not be properly identified. This facility existed within a row of commercial buildings and numerous attempts to determine exactly which buildings was used ended in failure. No physical evidence was found in any of the buildings that indicated a bank was housed therein, as the bank actually was being housed in a commercial structure not specifically built for it.

Overall, the group of buildings establishes a platform that provides specific information on the economic development of Ellis County and demonstrates that these facilities were instrumental in improving the economic base of this western Oklahoma county.

9. Major Bibliographical References

See continuation sheet.

10. Geographical Data

Acreage of nominated property See individual nominations

Quadrangle name _____

Quadrangle scale _____

UTM References

A	<input type="text"/>	<input type="text"/>	<input type="text"/>
	Zone	Easting	Northing
C	<input type="text"/>	<input type="text"/>	<input type="text"/>
E	<input type="text"/>	<input type="text"/>	<input type="text"/>
G	<input type="text"/>	<input type="text"/>	<input type="text"/>

B	<input type="text"/>	<input type="text"/>	<input type="text"/>
	Zone	Easting	Northing
D	<input type="text"/>	<input type="text"/>	<input type="text"/>
F	<input type="text"/>	<input type="text"/>	<input type="text"/>
H	<input type="text"/>	<input type="text"/>	<input type="text"/>

Verbal boundary description and justification

See individual nominations

List all states and counties for properties overlapping state or county boundaries

state	code	county	code
N/A			

11. Form Prepared By

name/title John Wensorski Supervised by Mary Ann Anders

organization Oklahoma Historical Preservation Survey date 1982

street & number 502 Math/Sciences, Okla. State University telephone (405) 624-5678

city or town Stillwater state Oklahoma

12. State Historic Preservation Officer Certification

The evaluated significance of this property within the state is:

national state local

As the designated State Historic Preservation Officer for the National Historic Preservation Act of 1966 (Public Law 89-665), I hereby nominate this property for inclusion in the National Register and certify that it has been evaluated according to the criteria and procedures set forth by the National Park Service.

State Historic Preservation Officer signature C E Metcalf date 8/8/83

title _____ date _____

For NPS use only

I hereby certify that this property is included in the National Register

See Continuation Sheet for listing date 8/8/83

Keeper of the National Register

Attest: _____ date _____

Chief of Registration

UNITED STATES DEPARTMENT OF THE INTERIOR
NATIONAL PARK SERVICE

**NATIONAL REGISTER OF HISTORIC PLACES
INVENTORY -- NOMINATION FORM**

FOR NPS USE ONLY

RECEIVED

DATE ENTERED

CONTINUATION SHEET

ITEM NUMBER #9

PAGE 1

Major Bibliographical References:

Interviews:

William Brown, 30 June 1982.
Vernie Oates, 30 June 1982.
Carl Mason, 30 June 1982.
Edgar Johns, 30 June 1982.
Harry Swartz, 29 June 1982
John Harger, 29 June 1982.
Henry Busch, 29 June 1982.
R. N. Higgins, 28 June 1982.
Winnifred, Lahann, 28 June 1982.
Laura Woodward, 28 June 1982.
Bruce Benbrook, 18 May 1982.
Anna Mae Lentz, 18 May 1982.
Ned Stuart, 18 May and 28 June
Rhea Nine, 18 May and 30 June
Bonnie Brown, 19 May 1982
Lois Brown, 19 May 1982
Floyd Steinert, 19 May 1982
Bonnie Sapp, 19 May 1982

Sources:

Woodward County Journal, 15 Oct. 1959.
Our Ellis County Heritage, vol. 1&2, Oklahoma City
Ellis County Historical Society, 1979.
A Pioneer History of Shattuck, Oklahoma City:
Citizens of Shattuck, 1970.

MAP OF FARGO, OKLAHOMA

PLATTED AS OLETA
ELLIS COUNTY

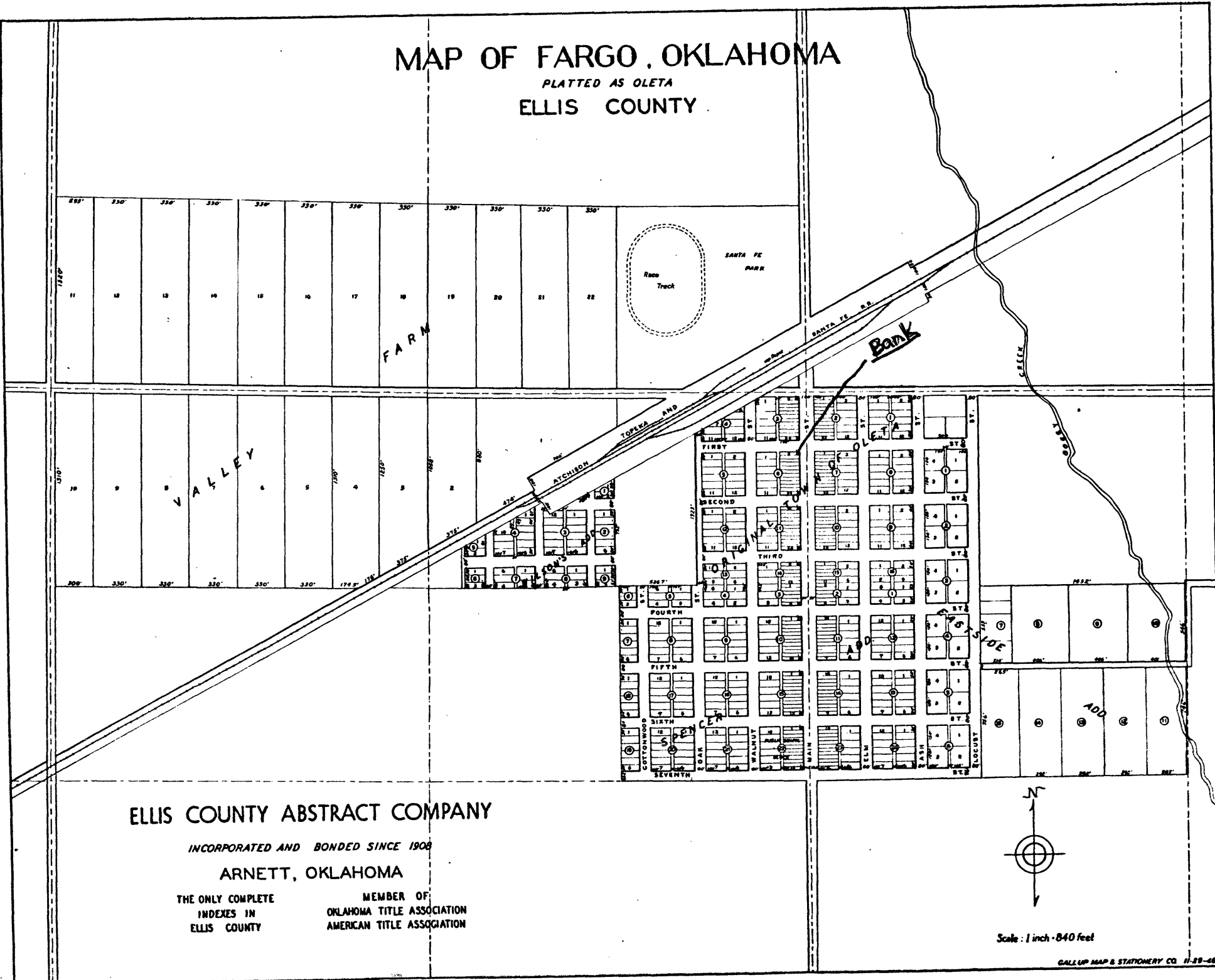

ELLIS COUNTY ABSTRACT COMPANY

INCORPORATED AND BONDED SINCE 1908

ARNETT, OKLAHOMA

THE ONLY COMPLETE
INDEXES IN
ELLIS COUNTY

MEMBER OF
OKLAHOMA TITLE ASSOCIATION
AMERICAN TITLE ASSOCIATION

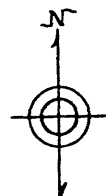

Scale: 1 inch = 840 feet

United States Department of the Interior
National Park Service

National Register of Historic Places
Inventory—Nomination Form

For NPS use only
received 8/26/83
date entered

Continuation sheet

Item number

Page

Multiple Resource Area
Thematic Group

dnr-11

Name Banking Facilities in Ellis County Thematic Resources
State Oklahoma

Nomination/Type of Review

Date/Signature

- 1. Bank of Gage
Keeper Linda M. Clelland 10-7-83
Attest _____
- 2. Bank of Shattuck **Substantive Review**
Keeper Reject
Attest _____
- 3. Farmers and Merchants Bank
Keeper Reject
Attest _____
- 4. Farmers State Bank Building-
First State Bank **Substantive Review**
Keeper Reject
Attest _____
- 5. First State Bank
Keeper Linda M. Clelland 10/7/83
Attest _____
- 6. Shattuck National Bank Building **Substantive Review**
Keeper Linda M. Clelland 10/7/83
Attest _____
- 7. Stock Exchange Bank **Substantive Review**
Keeper Linda M. Clelland 10/7/83
Attest _____
- 8. _____
Keeper _____
Attest _____
- 9. _____
Keeper _____
Attest _____
- 10. _____
Keeper _____
Attest _____